

MURRAY COUNTY.

Section 1
10798 McGill-Warner Co., Blank Book Manufacturers, St. Paul.

Township 105

Range 40

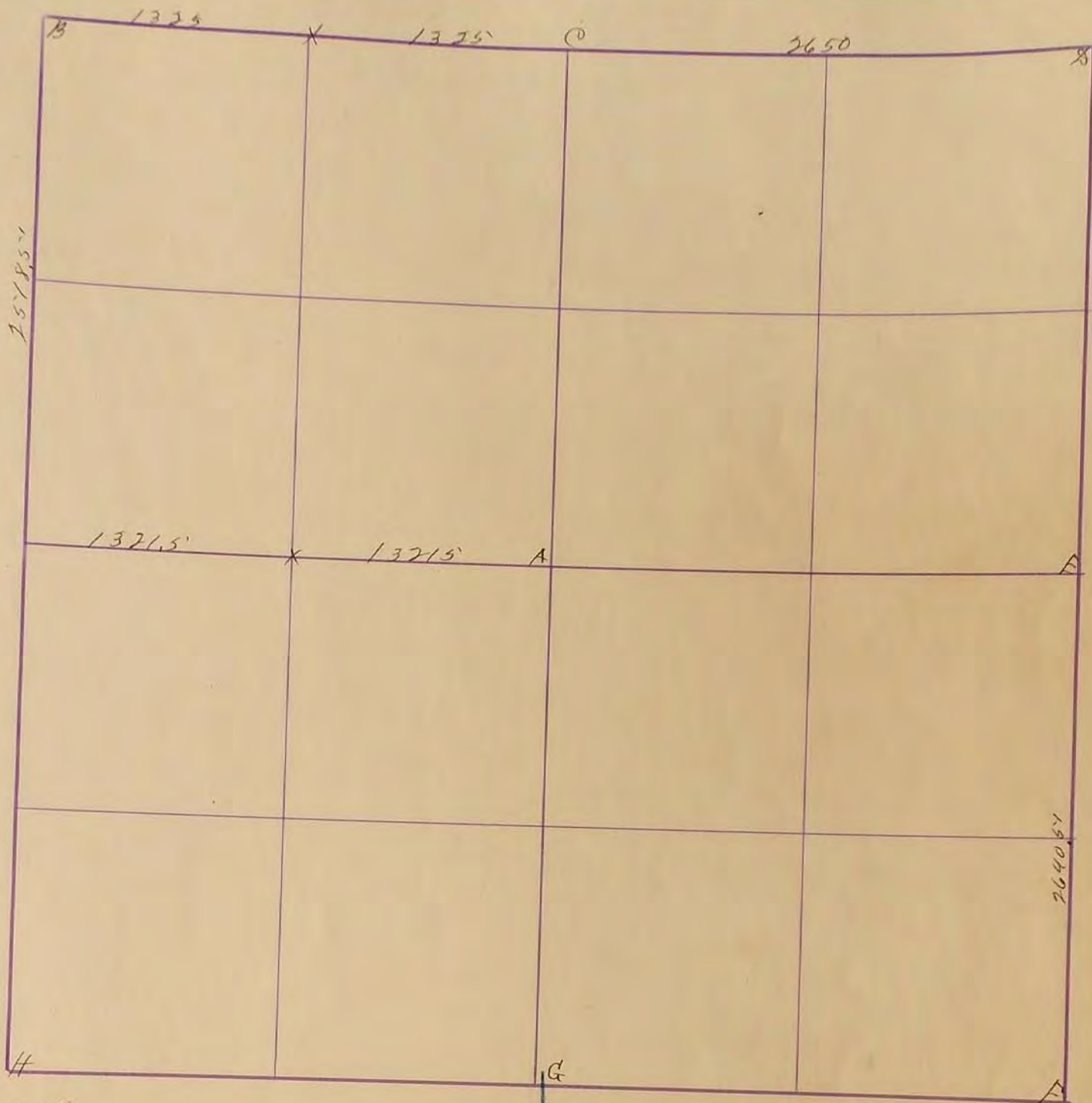

Apr. 18-1975

- A. Small stone to be replaced by fence Post
 - B. Blasted stone
 - C. stacks with large stone on west side and 3 small stones
 - D. Township corner
 - E. Stone. Blue & white granite 14x14x26 east of grade
 - F. stone S.E. of center of grades
 - F. cor. 29 ft. S.E. F. Cor. 45' S.W. F. Cor. 48 ft. W.
 - F. cor 37.7' N.E.
 - G. stone at end of grade
 - H. see see 1
 - I. stone on line with fence on See 2
 - X stones
- "F" Located Conc. Monument at Gravel Surface Mar. 27, 1973
R.P. N&C Cor Post SE. 41.16; R.P. N&C. P.P. SW. 45.88
- "E" Located Field Stone at East Shoulder of Road, 0.5' cover, Mar. 27, 1973
R.P. N&C Fence Post East in Line 58.83
- "D" Located Field Stone 1.0' Below Gravel Surface Mar. 29, 1973: R.P. N&C
T.P. SE. 35.96; R.P. Nail in 2x2 Hub NE. 48.21; R.P. Nail in 2x2 Hub NW. 59.80

1
2
3
4
5
6
7
8
9
10
11
12
13
14
15
16
17
18
19
20
21
22
23
24
25
26
27
28
29
30
31
32
33
34
35

SURVEY No. _____

Section 1 Town 105 Range 40

2650

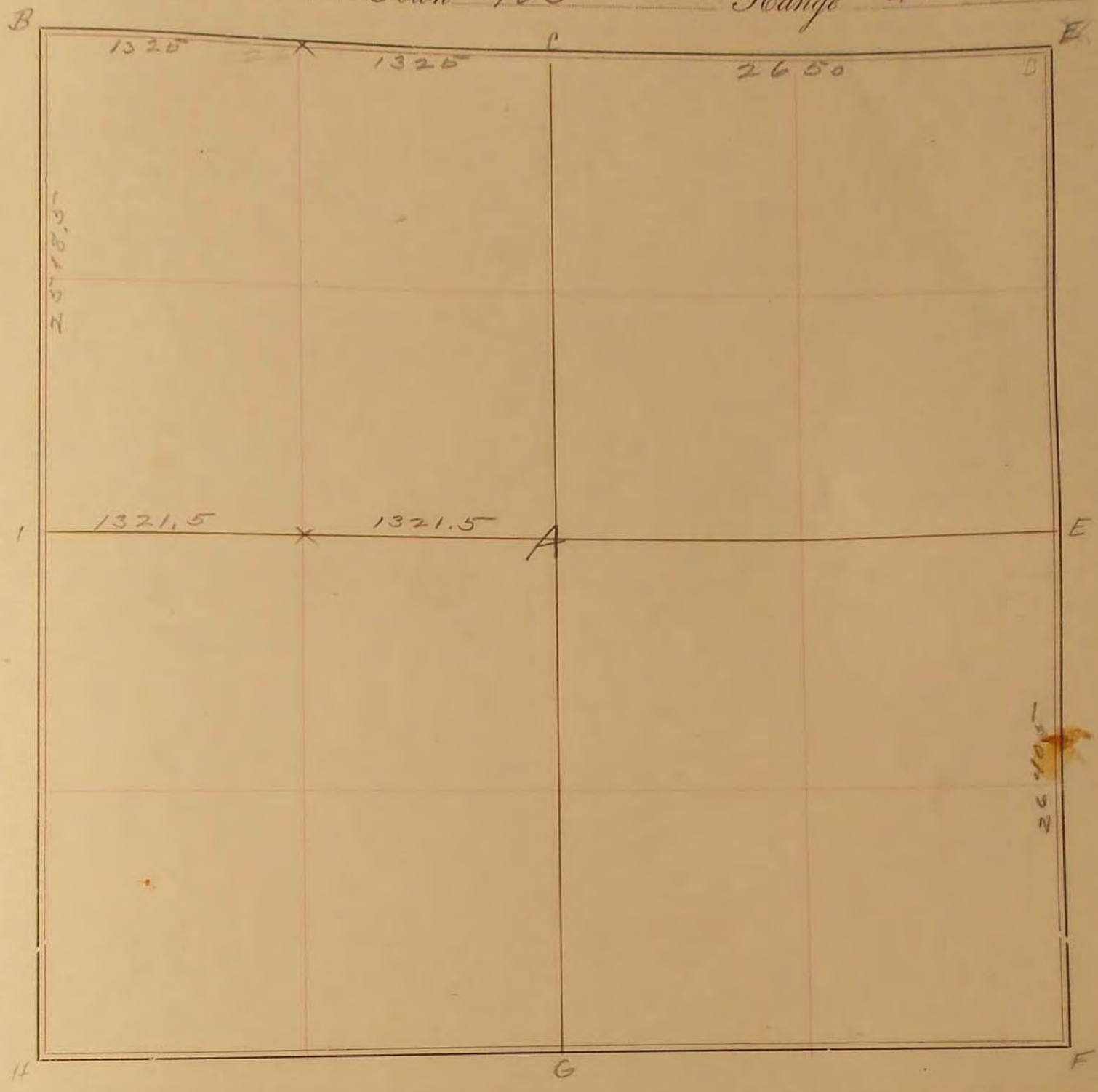

FIELD NOTES.

Apr. 16, 1925

- A Small stone to be replaced by fence post
- B Bleached stone.
- C Stake with large stone on west side and 3 small stones
- H Top cut
- E Stone Blue & white granite 14x14x26" east of grade
- F Stone SE of center of grade. F. cor. 29° SE, F. cor. 45° SW - F. cor. 48° N.W., F. cor. 327° NE
- G Stone at end of grade
- H to sec. 2
- I Stone on line with fence on sec. 2
- X Stones